



Description

The temperature sensor serie SCK measures the temperature from -50 up to +100°C on pipes or round surfaces. The range is available with all type of current sensor elements.

Technical specifications

Measurement range	-50...+100°C
Sensor	Pt100, Pt1000, Ni1000, NTC, KTY.
Type of connection	2 fili
Measured current	approx. 1 mA
Electrical connection	Screw terminal block for wires up to 1,5 mm ²
Housing	PA6, RAL9010
Cable entry	M16 high-strength cable gland with strain relief
Protection type	IP65
Storage temperature	-20...+70°C
Installation	Mounting flange (included)
Standards	CE conformity, RoHS



Models	Type of sensor
SCK1	Pt100 (DIN EN 60751 Cl. B)
SCK2	Pt1000 (DIN EN 60751 Cl. B)
SCK3	Ni1000 (TK6180)
SCK4	Ni1000 (TK5000)
SCK5	NTC20k (±1%)
SCK6	NTC10k (±1%) BETA 3435K
SCK7	KTY 81-110 (±1%)
SCK8	KTY 81-121 (±1%)

Dimensions (mm)

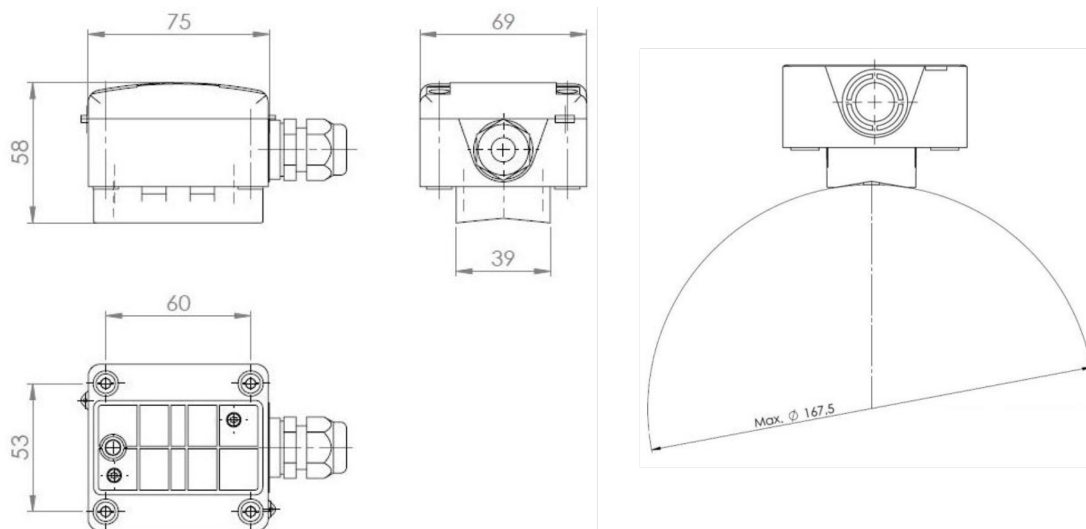

The contents are subject to revision or change without notice.